

# ***SPREADMASTER***



## **PTP Series**

**OPERATING INSTRUCTIONS AND SPARE PARTS**  
**READ CAREFULLY BEFORE OPERATING MACHINE**

July 2006

## Contents

Introduction .....	page 2
Technical Specifications.....	page 2
1. Important Safety Information.....	page 3
1.1 Using this Manual .....	page 3
1.2 General.....	page 3
1.3 Safe Operation of the Machine .....	page 4
1.4 Travelling on Roads.....	page 5
1.5 Safety Decals.....	page 5
2. General Information .....	page 6
2.1 ID/Name Plate .....	page 6
2.2 Machine Overview .....	page 6
3. Operation .....	page 7
3.1 Connection .....	page 7
3.2 Adjustments .....	page 8
3.2.1 Spreader Vanes Adjustment	
3.2.2 How to Adjust the Spreader	
3.3 Loading Hopper .....	page 9
3.4 Application of Fertiliser .....	page 9
3.5 Spreading Errors.....	page 10
4. Maintenance.....	page 11
4.1 Lubrication .....	page 11
4.2 Replacement of Spreader Vanes.....	page 12
4.3 Storage .....	page 12
4.4 Spare Parts.....	page 12
5. Warranty.....	page 13
Spare Parts Manual .....	page 15

## Introduction

These trailed spreaders are designed exclusively for the spreading of solid, granular fertilisers and seeds in the field. The machines are intended to be used with small/medium power tractors or with quad ATVs. If it required to operate these machines at night or under poor lighting conditions, then the tractor or ATV lights must be used.

It is recommended that you carefully read this manual, and follow the guidelines to ensure safe and efficient operation of the machine. This manual has been written to give the customer all the information and safety rules for the machine, as well as maintenance instructions that let the machine be used in a safe and efficient manner.

This manual must always be kept handy, and in good readable condition. If it gets misplaced or damaged contact your local Agriquip dealer who will supply a replacement.

In the event of difficulties or questions contact your Agriquip dealer who will be able to assist you.

The machine is only to be used for the spreading of solid, granular fertilisers and seeds in the field. Improper use or modification negates the warranty. Neither the manufacturer, nor Agriquip, is responsible for any injury or damage resulting from improper use or modifications.

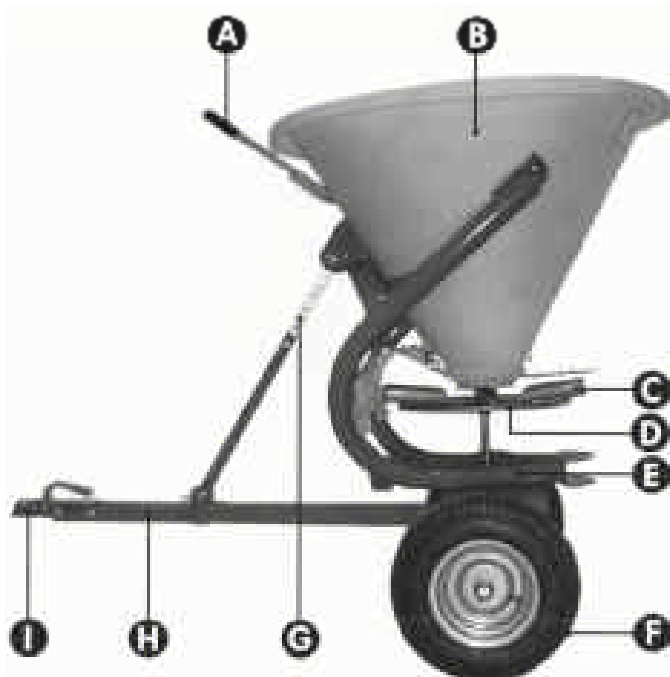

- A     Regulating Lever
- B     Plastic Hopper
- C     Distributor Vanes
- D     Spreader Disk
- E     Steel Frame
- F     Tyres
- G     Drawbar Adjustment Rod
- H     Drawbar
- I     Drawbar Connection

## Technical Specifications

	PTP 180	PTP 300
Hopper Capacity	165 kg	260 kg
Tare Weight	80 kg	84 kg
Overall Width	1050 mm	1050 mm
Loading Height	1300 mm	1440 mm
Overall Length	1500 mm	1500 mm
Hopper Width	900 mm	1050 mm
Ball Hitch Diameter	45 mm – 50 mm	45 mm – 50 mm
Tyres	6.5 x 3.2	6.5 x 3.2
Spreading Width	8 m - 12 m	8 m - 12 m
Spreading Rate	27 ha/hr - 55 ha/hr	27 ha/hr - 55 ha/hr



## 1. Important Safety Information

### 1.1 Using this Manual

This manual gives all the information for the use and maintenance of the machine. The effective working life depends on good maintenance and to the attention paid during use. Some pictures in this manual show details or accessories that could be different from those of your machine, some components may have been removed from the picture for the purpose of clarity.

Some important signal words are put on the machine and the operator is to ensure that they in a good readable condition, replacing them if necessary.



The symbol on the left above the following words:

DANGER  
ATTENTION  
WARNING

is used in this manual to highlight important safety and working messages. Pay particular attention to these messages to ensure safe and efficient use of the machine.

**The use of original spare parts and accessories is recommended. The use of non-original parts, besides rendering the warranty null and void, could be dangerous and reduce the life and performance of the machine.**

### 1.2 General

---

**THE FOLLOWING RECOMMENDATIONS ARE MADE TO SAFEGUARD YOU THEREFORE READ THEM CAREFULLY, COMMIT THEM TO MEMORY AND ALWAYS HEED THEM.**

---

**The warnings in this manual apply only to the normal use of the spreader for distributing fertiliser and seeds and cover reasonably foreseeable hazards. All the instructions must be applied with common sense and regards to the work experience of the operator, taking all practical steps to prevent accidents.**

- \* The machine must be used by a single operator.
- \* Do not allow children to ride on, or operate, the machine.
- \* Heed all instructions and safety notices.
- \* Modifications to the machine not authorised in writing by Agriquip, exclude their liabilities.
- \* Check the correct functioning of the machine, before every use.
- \* Read this manual carefully before proceeding to start, operate, or perform maintenance on the machine.
- \* Heed, in addition to the warnings in this manual, all the safety and accident prevention guidelines as laid out in the DoL Guides for the use of ATVs, tractors and fertiliser spreaders.
- \* Keep this manual handy, so as to refer to it, for operating and safety information.



ATTENTION

**Any maintenance work, cleaning or adjustments must be done with the spreader on the ground with the engine turned off and the key removed.**

- \* Read the safety decals on the machine carefully and follow the instructions. In case of wear and tear or insufficient readability of the safety decals, clean or replace them, placing the decals in the right position, as shown in section 1.5.



ATTENTION

**PERSONAL PROTECTIVE EQUIPMENT: The operator while using, maintaining, repairing, adjusting or storing the machine, must wear steel capped safety shoes and safety gloves. It is also recommended that suitable hearing protections such as earmuffs or earplugs, dust masks and safety glasses be worn.**

- \* While loading and operating there is the danger of inhaling fertiliser dust. It is suggested that either the tractors is fitted with filters on the cabin ventilation system, or that a suitable dust mask is used.

## 1.2 General Important Safety Information *(continued)*

- ✦ The machine is designed for use by a single operator who while the machine is in use, must remain at the control on the towing vehicle.
- ✦ Never operate the machine if you are tired, sick or after having taken alcohol, drugs or medication.
- ✦ Ensure the carrier vehicle's capacity is not exceeded.



**DANGER**

**It is forbidden to climb on or to transport somebody when the machine is in motion. Do not let anyone get inside the hopper for any reason.**

- ✦ Keep the machine free from foreign bodies (detritus, tools, miscellaneous), as they can damage the machine or the operator. In general fertilisers are rather corrosive so it is important that the fertiliser is not left in the machine for a long period of time. Clean the hopper and the distributor after each use.
- ✦ If during cleaning operations compressed air or a water jet is used, it is necessary to wear safety glasses and safety masks, keeping bystanders and animals away from the machine.
- ✦ Before connecting the machine to the tractor or ATV means check that this is in good conditions and that brakes function correctly, especially if you working on sloping ground.
- ✦ Only disconnect the machine from the towing vehicle on compact and level ground (with the hopper empty), checking that the machine is stable. Switch off the towing vehicle and remove the key.



**WARNING**

**During transport, loading and spreading of fertiliser, the operators must follow all the safety signage, hazard messages and the precautions to be taken.**



**ATTENTION**

**Neither Agriquip nor the manufacturer is liable for possible damage or injuries caused by improper and unforeseen use of the machine.**

- ✦ The Manufacturer is not responsible in case of:
  - improper use of the machine;
  - use by untrained staff;
  - serious deficiencies in the specified maintenance;
  - non-authorised modifications;
  - use of non-original spare parts;
  - total or partial non-observance of the instructions;
  - non-observance of common safety rules during work;
  - unusual/exceptional circumstances.

## 1.3 Safe Operation of the Machine

- ✦ Check the machine before switching on. Commence work only if the machine is in perfect condition.
- ✦ Before using the machine ensure that all the safety guards are correctly positioned and in good state; in case of breakage or damage, replace the guards immediately.



**ATTENTION**

**During use, ensure that there are not any person or animal within 50 metres. When working near roads or public places, it is your responsibility to keep persons away and to take any further precautions necessary.**



**ATTENTION**

**Anyone who approaches the machine is in a danger area, therefore they become "AN EXPOSED PERSON". The operator must prevent anybody entering the danger area and work with the maximum caution. If somebody enters the danger area immediately turn the engine off.**

- ✦ Before every use always check the vanes and spreader disc for wear. Check that all screws and bolts are in place and tight.
- ✦ The machine must never be unattended when in motion.
- ✦ Always keep the machine in good operating condition and maintain regularly.

## 1. Important Safety Information *(continued)*

### 1.4 Travelling on Roads



ATTENTION

Follow all LTSA rules and regulations when moving the machine on public roads. Before travelling on public roads, it is compulsory to empty the hopper.

While travelling on public roads, as well as heeding any LTSA regulations and conditions applicable to the towing vehicle, it is important to pay special attention to choosing an appropriate speed especially when the road is busy, winding or inclined.

If the spreader obscures the rear signalling lights of the towing vehicle, it will be necessary to fix a light bar and/or some back signalling device.

While travelling on the road, the gearbox must not be engaged. Disengage the drive by removing the drive pin from the axle, as shown in the picture.

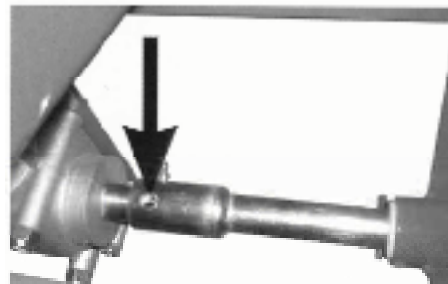

### 1.5 Safety Decals



ATTENTION

Be sure that the safety decals are readable. Clean them using a cloth, water and soap. Replace damaged labels replacing them in the correct location, as described below.

The safety decals on the machine provide the most important safety information. Heeding them helps ensure your safety.



(1) ATTENTION! Before making any adjustments to the machine, stop the engine of the towing vehicle, remove the key, put on the parking brake and read the operator's manual carefully.



(2) ATTENTION! – DANGER! Possible throwing of material and/or objects. Do not stop or approach the machine. Keep a safety distance of at least 50 metres from the machine.



(3) ATTENTION! – DANGER! Do not enter the hopper or carry passengers.



(4) ATTENTION! Personal Protection Equipment required.



## 2. General Information

### 2.1 ID/Name Plate

Near the bottom of the hopper of every machine is an ID plate giving:

- Model;
- Serial number; and,
- Year of construction of the machine.

**When ordering spare parts, it is necessary to quote the type of machine, model number, serial number and the year of manufacture.**

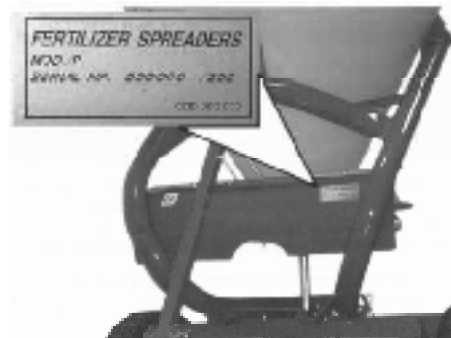

### 2.2 Machine Overview

The PTP series of fertiliser spreader have a stainless steel distributor equipped with a spreader disc with four adjustable vanes in four different positions, in order to obtain the maximum spreading precision and uniformity in the distribution, irrespective of the kind of product that must be spread.



The feeding of the disc is by gravity through an opening located on the bottom of the hopper. Inside the hopper is a mixer/agitator to prevent the formation of lumps of fertiliser.

A metal plate is fixed in front of the disc, to prevent the fertiliser or seeds being thrown forwards onto the operator, or towing vehicle.

Fertiliser delivery is controlled by opening the shutters in the bottom of the hopper bottom by means of lock devices operated by levers. The fertiliser spreader and the agitator are connected through a gearbox to the wheels, so as to allow rotation of the disc directly proportionate to the speed of the machine. The drive can be connected or disconnected by inserting or removing the split pin on the axle.



**Delivery Control Levers**

The machines can be supplied with a 45 millimetres (1-7/8") or 50 millimetres (2") ball hitch. A height adjustable drawbar is available on all models for keeping the disc parallel to the ground.

The robustness of the steel welded frame, together with the remarkable life of the plastic hopper, makes this a drawn spreader of the highest quality.

The spreader is coated with an epoxy varnish baked on at 150°C after a primer bath, assuring great protection and long life for the machine.

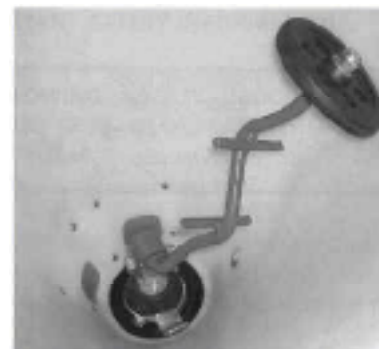

**Agitator**



**Height Adjustment**



### 3. Operation



ATTENTION

Before use, please check that all gears are adequately greased ( see section 4.1).



ATTENTION

During use ensure that for a radius of 50 meters there are no persons or animals. If someone approaches within this distance stop immediately the towing vehicle's engine.

#### **Recommendations for Correct Distribution**

- ✦ Check the application rate (kg/ha) that you wish to spread before starting work.
- ✦ Use fertiliser in perfect condition – a damp fertiliser will not spread uniformly and correctly.
- ✦ Avoid spreading fertiliser in windy conditions in order to improve uniformity of distribution.

#### **3.1 Connection**

The PTP series spreaders can be hitched to every type of tractor or ATV-quad with ball of 45 millimetres (1-3/4") or 50 millimetres (2"). To make the connection, it is necessary to put the tow ball into the coupler on the spreader, locking it by pushing the lock handle downwards. Check and adjust the length of the draw bar adjustment rod, so that the spreader disc is, as parallel as possible, to the ground. This will ensure uniform and regular distribution of the fertiliser.

Unscrew the locking bolt, as shown with the arrow in the picture below and move the rod in the optimal position, in correspondence of the present holes and lock the bolt in the new position.



**Draw-bar Adjustment Rod**



**Correct Orientation of the Spreader Disc**



### 3. Operation *(continued)*

#### 3.2 Adjustments

It is not possible to have an accurate spreading chart for equipment that makes use of the centrifugal principle, as the distributed quantity depends on the speed, radius of distribution, as well as the quality and humidity of the fertiliser and on the roughness of the land. The fertiliser must always be adequately stored so as to conserve its physical characteristics. It is necessary to determine the speed of the spreader to achieve the required application rate before starting spreading, trying, within possible limits, to keep it constant for the entire duration. The spreading charts contain indicative information that an experienced and competent operator can use to determine the quantity to spread in the field.

##### 3.2.1 Spreader Vanes Adjustment

In order to assure a homogenous distribution on both sides of the spreader, depending on the differing specific weights of the fertiliser used, the distributor vanes on the disc can have different positions. When all the vanes are put in hole 1 (*as shown in the picture*), the distribution of the product is increased towards the left-hand side relative to the direction of travel. Conversely, if the vanes are put in hole 4, the distribution will be more towards the right. Moving the vanes from position 1 to position 4 will result in an increase in the width of the distribution at the same ground speed.



Such adjustments must be made depending to the type and nature of fertiliser being spread and the operator's experience.

##### 3.2.2 How to Adjust the Spreader

Spreading is adjusted by means of the regulation lever that opens the aperture at the bottom of the hopper. In order to carry out the adjustment, after having consulted the spreading table, depending to the type of product to spread and to the ATV speed, it is necessary to move the lever "A" along the graduated scale "E" and lock it in the chosen position with the pin "D".

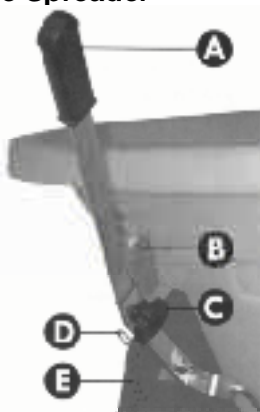

SPREADING CHART											
SPREADING CHART FOR FERTILIZER						SPREADING CHART FOR SEED					
		QUANTITY SPREAD IN LBS/ACRE AT VARIOUS GATE SETTINGS									
		SPEED (MPH)									
		1	2	3	4	5	6	7	8	9	10
		1	2	3	4	5	6	7	8	9	10
LARGE	2.5	132	240	402	635	929	1314	1746	2280	2952	3744
GRANULAR	5.0	66	120	201	318	465	657	873	1140	1476	1872
FERTILIZER	7.5	44	80	134	212	310	438	582	756	984	1248
MEDIUM	2.5	—	211	346	550	825	1178	1610	2124	2752	3504
GRANULAR	5.0	—	106	173	275	413	589	805	1062	1376	1752
FERTILIZER	7.5	—	71	115	183	275	386	524	696	912	1168
FINE	2.5	112	188	322	526	747	1042	1402	1824	2312	2968
GRANULAR	5.0	56	94	161	263	374	521	701	912	1156	1484
FERTILIZER	7.5	37	62	107	175	249	347	468	616	792	1016
CRYSTAL	2.5	226	366	606	966	1386	1956	2652	3480	4464	5712
AMMONIAL	5.0	113	183	303	483	693	978	1326	1740	2232	2856
SULPHATE	7.5	75	122	202	322	462	642	862	1122	1442	1822
THOMAS	4.0	—	—	571	—	1278	—	1825	—	2544	—
MEAL	6.0	—	—	306	—	655	—	945	—	1284	—

In order to spread from both sides (reference I) levers "A" and "B" must be in the same position, connected through grip handle "C".

In order to spread to one side only it is necessary to disconnect the two levers by removing the "C" grip handle. To spread to the left (reference II); set the lever "B" in the chosen position, given by the spreading chart, and move the lever "A" upwards (position 1) in order to close the right-hand shutter. In order to spread only to the right (reference III) you have to move lever "B" up (position 1) and adjust the quantity according to the spreading chart with lever "A".

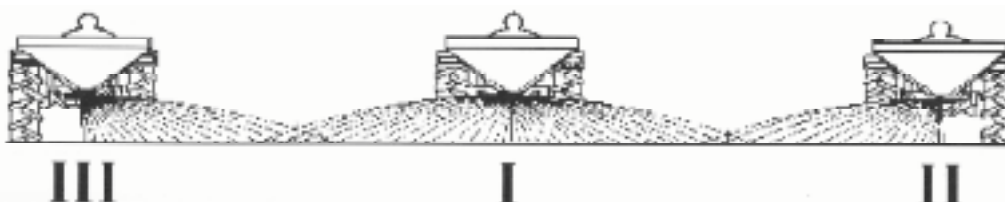

3. Operation (*continued*)

## 3.3 Loading Hopper

It is recommended that hopper loading not be performed manually but by using a crane or other suitable mechanical means.



ATTENTION

The hopper must be loaded only after the spreader is securely connected to the towing vehicle.

Do not drive for very long distances with a full load and do not put full bags of fertiliser in the hopper while travelling to the field or during operation. This is to prevent exceeding the weight carrying capacity of the spreader and compression of the fertiliser.



WARNING

During the transport, handling and use of fertiliser, the operator must comply with all the precautions stated on the product packaging and heed any hazard warnings.

## 3.4 Application of Fertiliser



ATTENTION

While operating, maintaining, repairing, transporting or storing the machine, steel capped safety shoes and gloves must be worn. It is recommended that hearing protection, dust mask and safety glasses be also worn during loading and spreading.

After having connected the spreader to the towing vehicle and carried out the necessary checks and taken the necessary safety precautions, it is possible to begin work.



ATTENTION

Before alighting from the towing vehicle and before every maintenance and/or adjustment operation, engage the parking brake, turn off the engine, remove the ignition key and wait for all moving parts to stop.

Only insert the drive pin into the axle, so that the spreader can be driven by the wheels, immediately before commencing spreading of the fertiliser.

Various ways exist to spread the fertiliser over the field. One of the simplest methods is, as follows:

- Position the towing vehicle at the beginning of the field you intend to fertilise at half the spreading width from the edge ( $D/2$ ) that is the half of the working width that is used (point 1);
- Drive around the perimeter of the field distributing the fertiliser;
- Stop the tractor at one distance ( $D$ ) from the point 1, equivalent to the set working width (point 2);
- Beginning the spreading proceeding in a line, straight to point 3.
- Turn the tractor and drive a  $D$  distance, equal to the working width (point 4);
- Repeat the process until all the plot is covered.

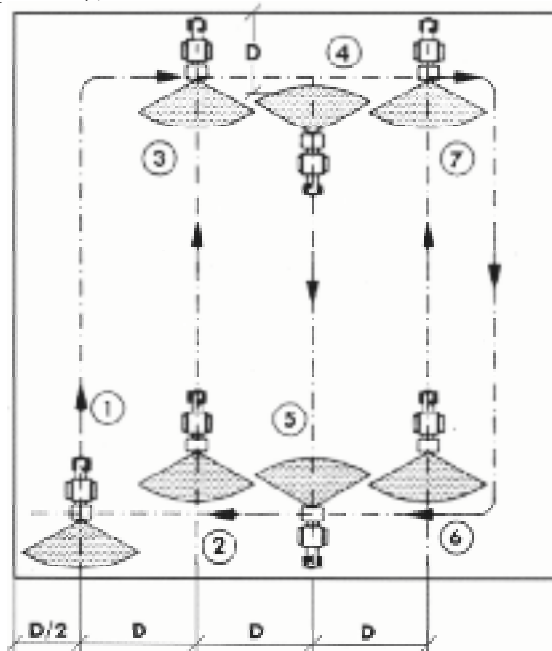
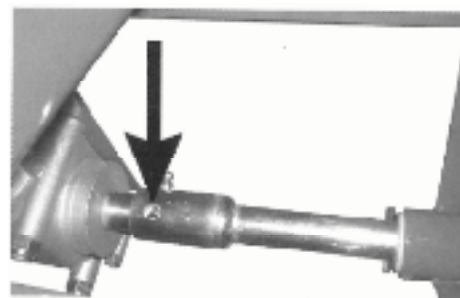

### **3. Operation** *(continued)*

#### **3.5 Spreading Errors**

##### **Errors in Use**

- ✦ Drive speed;
- ✦ Incorrect spreading width;
- ✦ The spreading disc is not in a horizontal position compared to the land;
- ✦ Drive speed is different to that suggested by the spreading tables, or is not suitable for that particular type of fertiliser;
- ✦ Each path taken is not at the correct distance from the previous track;
- ✦ Distributing discs dirty.

##### **Errors Caused by the Fertiliser**

- ✦ Fertiliser of poor quality.
- ✦ Wet or damp fertiliser;
- ✦ Incorrect fertiliser composition or it does not correspond to what vendor says it is;
- ✦ Lumps in the fertiliser – either big lumps or an excessive number of lumps;
- ✦ Foreign matter in fertiliser.

##### **Errors Caused by the Spreader**

- ✦ Spreading exits clogged;
- ✦ Parts of the spreading disc worn away or damaged.

## 4. Maintenance

The normal maintenance regime that we suggest is based on the manufacturer's experience and on the advice and suggestions from customers. The maintenance periods suggested may changed as more history is established. A good routine maintenance programme keeps the operating costs of the machine low and provides a full realisation of its potential.



ATTENTION

**Any maintenance work, cleaning or adjustments must be done with the spreader on the ground with the engine turned off, brake set and the key removed.**

In the event of damage occurring, stop the machine immediately, assess the problem and proceed with remedial actions on the machine. If pressured water or compressed air is used for it will be necessary to protect oneself with safety goggles glasses or protection masks and to remove all people and/or animals from the vicinity of the machine. Do not use flammable solvents for cleaning.



ATTENTION

**While maintaining or repairing the machine, steel capped safety shoes and gloves must be worn. Take all practical steps to avoid the possibility of injury or damage.**

**Every 8 hours of operation check the tightness of all nuts and bolts.**

In case of unusual vibrations, check:

- ✦ the amount of spreading vane wear;
- ✦ the tightness of all the nuts and bolts; and,
- ✦ the lubrication of the gear box.

Excessive vibration of the machine, besides being annoying, is dangerous and may damage the entire structure by subjecting the mechanical parts to increased stress.

If you are unsure of the actions to be taken, or need to replace damaged or broken parts not shown in this manual, then refer to your local Agriquip dealer.

### 4.1 Lubrication

**Before every use and after every 8 hours of operation, grease the machine.** It is good practice to ensure the grease nipples are completely free from mud or other deposits before lubricating.

Lubricate the points shown in the picture with lithium grease.

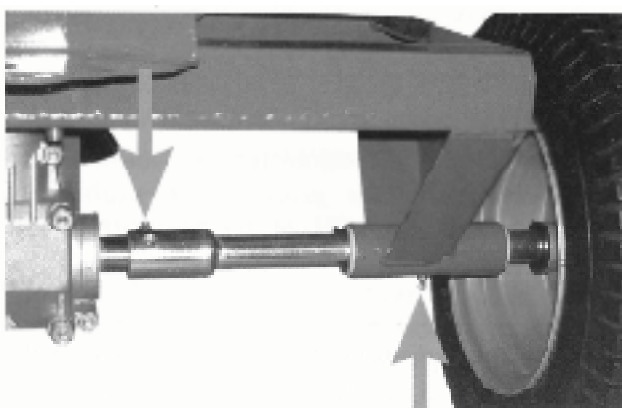
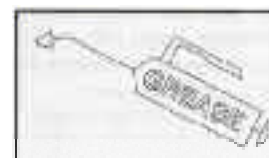

## 4.2 Replacement of Spreader Vanes

In the event of the spreading vanes break or get damaged, it is necessary to replace them with new ones. Unscrew the nut and replace the damaged vane. The nuts and bolts used must be of the same type and specification as the original.

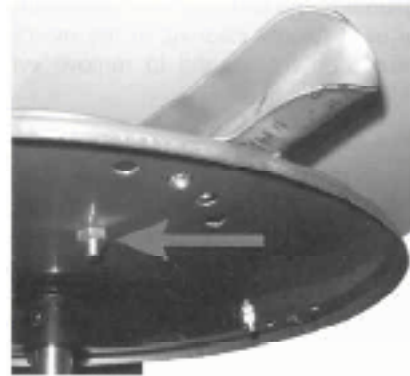

## 4.3 Storage

Do not wait until you are ready to use the machine before carrying out repairs and maintenance. Repair and replace broken or damaged parts before storage so that the machine is always ready for use. Store the machine in a sheltered place away from the weather and protect it in order to avoid deterioration. **Fertilisers are corrosive so it is important that no fertiliser remains on the machine** for long periods of time. Before storing the machine for long periods, it is recommended that the following actions are taken:

- ✦ thoroughly wash the machine and the inside of the hopper;
- ✦ inspect the machine for structural damage, retouch and chips or scratches in the paint;
- ✦ check that the safety decals are present, intact and readable. Replace if they are missing or unreadable (*refer section 1.5*);
- ✦ grease all the mechanical parts (*refer section 4.1*);

## 4.4 Spare Parts

When replacing parts use manufacturer's original parts, ordering them directly from your authorised Agriquip dealer. When ordering replacement parts it is necessary to quote the following information off of the ID plate:

- serial number;
- model;
- year of manufacture; and,
- frame number.

## 5. Warranty

**The PTP series are sold with a warranty valid for a year from the delivery date**, subject to the following conditions:

- ✦ In the event that a defective part(s) is found within one year from the date of delivery of the machine to the customer, Agriquip is to inspect the defective part. If as a result of this inspection it is deemed that it is a material or manufacturing defect it will be repaired, or at Agriquip's discretion, replaced free of charge.
  - ✦ The customer on delivery must check for damage, if damage is found the consignment must be endorsed accordingly. The customer must verify that the machine is the model ordered, and that it is complete with all the ordered accessories. If any discrepancies are noted, then Agriquip must be notified within seven days of the date of delivery.
  - ✦ The warranty excludes:
    - a) normal wear;
    - b) breakage or damage resulting from negligence or due to the use of the machine for other than the spreading of granular fertiliser and seeds;
    - c) damage resulting from modifications made without Agriquip's written authorisation, or the use of non-genuine replacement parts;
    - d) the warranty is void if the serial number of the machine has been modified, removed or made illegible.
- Where the damage is not covered by the warranty, the purchaser has to bear the cost of replacement parts, labour, transport, and any other incidental costs associated with replacement of the broken or damaged parts. Neither Agriquip nor the manufacturer is liable for any direct or indirect costs due to breakage or wear. Neither are they liable for any actions arising from proper or improper use.
- ✦ Defects that are not clearly attributable to materials or manufacture, shall be checked by the manufacturer's Technical Attendance Centre. If the claim turns out to be unjustified, all the repair costs and/or substitution of the damaged parts are to be born by the purchaser.
  - ✦ All parts will be invoiced at the time of shipment. In the event of the claim being upheld (on inspection of the damaged parts) the purchaser will be credited

Neither Agriquip nor their agents are responsible for any loss or damage occurring during transport.

This warranty is not transferable.



# *SPREADMASTER*



## **PTP Series**

### **Trailed Fertiliser Spreaders**

# **Spare Parts Manual**

Imported & Distributed by:

**AgriQuip**  
AGRICULTURAL IMPLEMENT WHOLESALES  
P.O. Box 578 30 Hurlstone Drive New Plymouth  
(06) 759 8402 NEW PLYMOUTH



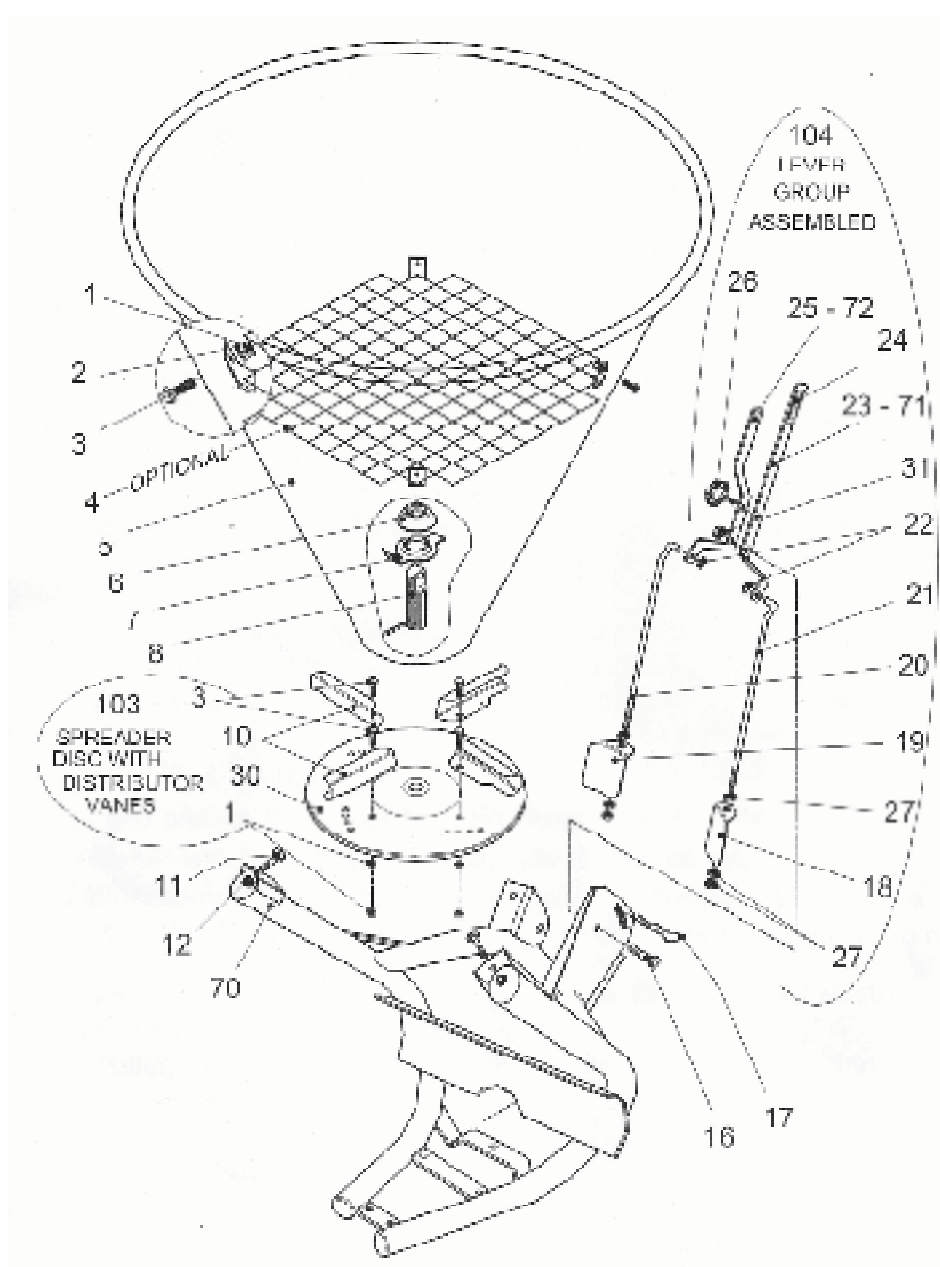

ITEM	QTY	PART No	DESCRIPTION
1	4	301.012	NUT M8 UNI 5588
1	4	301.012	NUT M8 UNI 5588 for grill
2	3	303.007	WASHER 8X17 UNI 6592
2	4	303.007	WASHER 8X17 UNI 6592 for grill
3	7	300.030	SCREW TTQST 8X16 UNI 5731
3	4	300.030	SCREW TTQST 8X16 UNI 5731 for grill
4	1	642.001	PROTECTIVE GRILL CE
5	1	609.008	HOPPER 180
5	1	609.038	PLASTIC HOPPER 180
5	1	609.011	HOPPER 300
5	1	609.033	PLASTIC HOPPER 300
6	1	304.013	RUBBER RING
7	1	619.002	LOWER AGITATOR

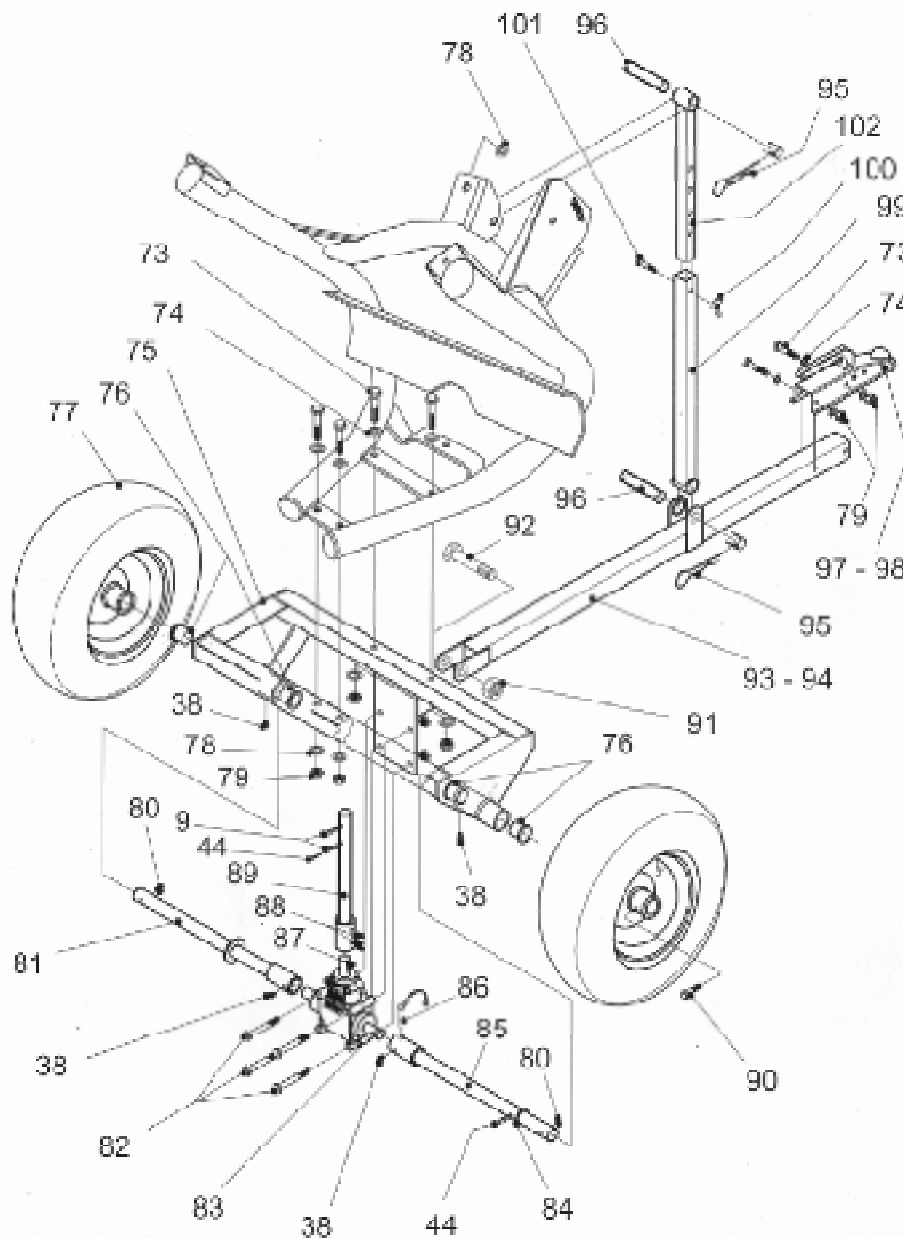

ITEM	QTY	PART No	DESCRIPTION
8	1	330.001	ENTRAINER
9	2	305.001	SPRING PIN 8X40
10	4	601.001	DISTRIBUTOR VANE
11	3	300.023	SCREW TTQST 10X20 UNI 5731
12	3	301.010	NUT M10 UNI 5588
16	1	300.024	SCREW TE 12X35 UNI 5739
17	1	307.001	SPLIT PIN 4,5
18	1	605.004	LEFT SHUTTER
19	1	605.003	RIGHT SHUTTER
20	1	602.001	RIGHT TIE ROD
21	1	602.002	LEFT TIE ROD
22	2	303.009	FLAT WASHER 10,5X21 UNI 6592 GR
23	1	604.002	LEFT LEVER SHORT VERSION

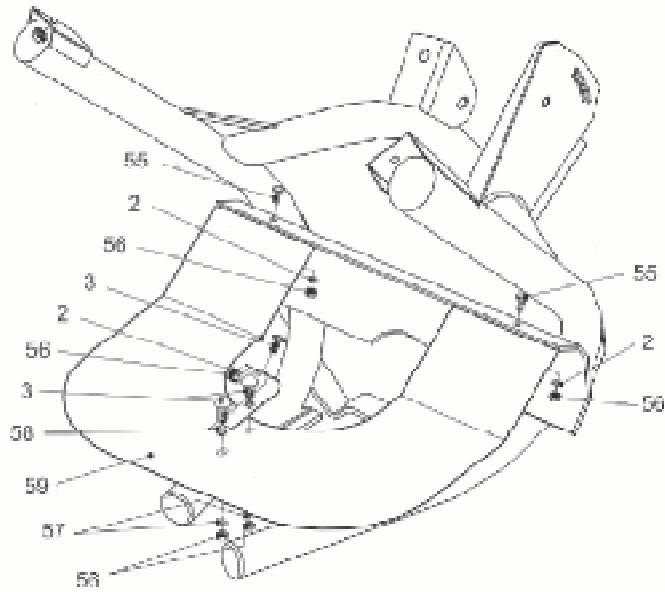
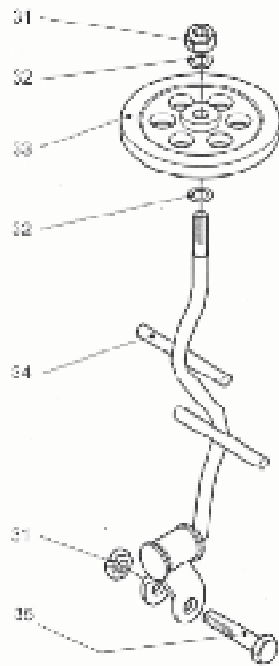

ITEM	QTY	PART No	DESCRIPTION
24	1	304.008	RUBBER GRIP
25	1	604.001	RIGHT LEVER SHORT VERSION
26	1	302.003	LEVER LOCK KNOB 8X25
27	6	301.014	NUT M10 UNI 5589 GR
30	1	610.003	SPREADER DISC without vanes
30	1	610.013	STAINLESS STEEL DISC without vanes
31	1	301.008	SELF LOCKING NUT M12
38	4	306.002	GREASE NIPPLE M8
44	2	305.003	SPRING PIN 5X40
55	2	300.029	SCREW TE 8X20 UNI 5739
56	5	301.012	NUT M8 5588
57	2	303.013	WASHER 8X24 UNI 6593
58	1	606.009	SUPPORT BRACKET
59	1	606.010	SHEET GUARD
70	1	613.026	PTP FRAME
71	1	604.005	RIGHT LEVER LONG VERSION
72	1	604.006	LEFT LEVER LONG VERSION
73	6	300.020	SCREW TE 10X70 UNI 5737
74	8	303.015	WASHER 10X20 UNI 6592
75	1	613.025	PTP SUPPORT FRAME
76	4	325.024	SMOOTH BEARING W/FLANGE
77	2	620.079	PTP TYRE
78	5	303.025	WASHER 10X30 UNI 6593
79	10	301.013	SELF LOCKING NUT M10
80	2	301.001	SELF LOCKING NUT M8
81	1	620.082	PTP RIGHT AXLE

ITEM	QTY	PART No	DESCRIPTION
82	4	300.018	SCREW TE 10X100 UNI 5737
83	1	322.008	GEAR BOX WITHOUT PTO
84	1	303.035	WASHER 25X351,5
85	1	620.083	PTP LEFT AXLE
86	1	302.006	PIN MM8
87	1	326.003	KEY 8X7X20
88	2	305.015	DOWEL M6
89	1	323.013	OUTPUT SHAFT WITH BUSHING
90	2	300.027	SCREW TE 8X50 UNI 5737
91	1	301.006	SELF LOCKING NUT M22
92	1	300.021	SCREW TE 22X80 UNI 5739
93	1	613.030	7/8 TOW TUBE FOR 1" 7/8 HOOK
94	1	613.031	TOW TUBE FOR 2" HOOK
95	2	305.008	SPRING PIN R 3
96	2	633.003	PTP PIVOT diam. 22
97	1	620.080	TOW HITCH 1" 7/8
98	1	620.090	TOW HITCH 2"
99	1	606.061	OUTER TUBE LEVEL STOP WITH BUSHING
100	1	301.005	DRAWBAR NUT M8
101	1	300.019	SCREW TE 8X40 UNI 5737
102	1	606.060	INNER TUBE LEVEL STOP WITH BUSHING
103		610.001	SPREADER DISC with vanes
103		610.014	STAINLESS STEEL DISC with vanes
104		618.006	LEVER GROUP ASSEMBLED RH+W short vers.
104		618.013	LEVER GROUP ASSEMBLED RH+LH long vers.
		619.004	AGITATOR PTP MODEL

Imported and Distributed by:

**AgricQuip**

AGRICULTURAL IMPLEMENT WHOLESALERS

P.O. Box 578 30 Hurlstone Drive New Plymouth

(06) 759 8402 NEW PLYMOUTH